

## KIPP 100 ABATTANT NEWS 2014

ANODISATIONS NOIR(16) & TOPAS(15) ET EPOXY AUTRES COULEURS SUR DEMANDE

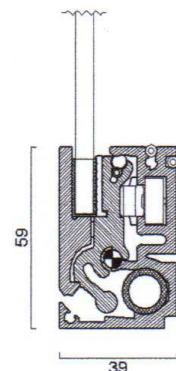

1.2.13.1

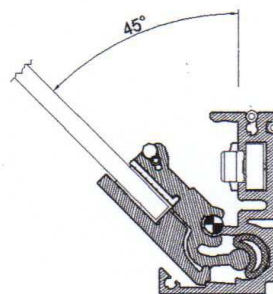
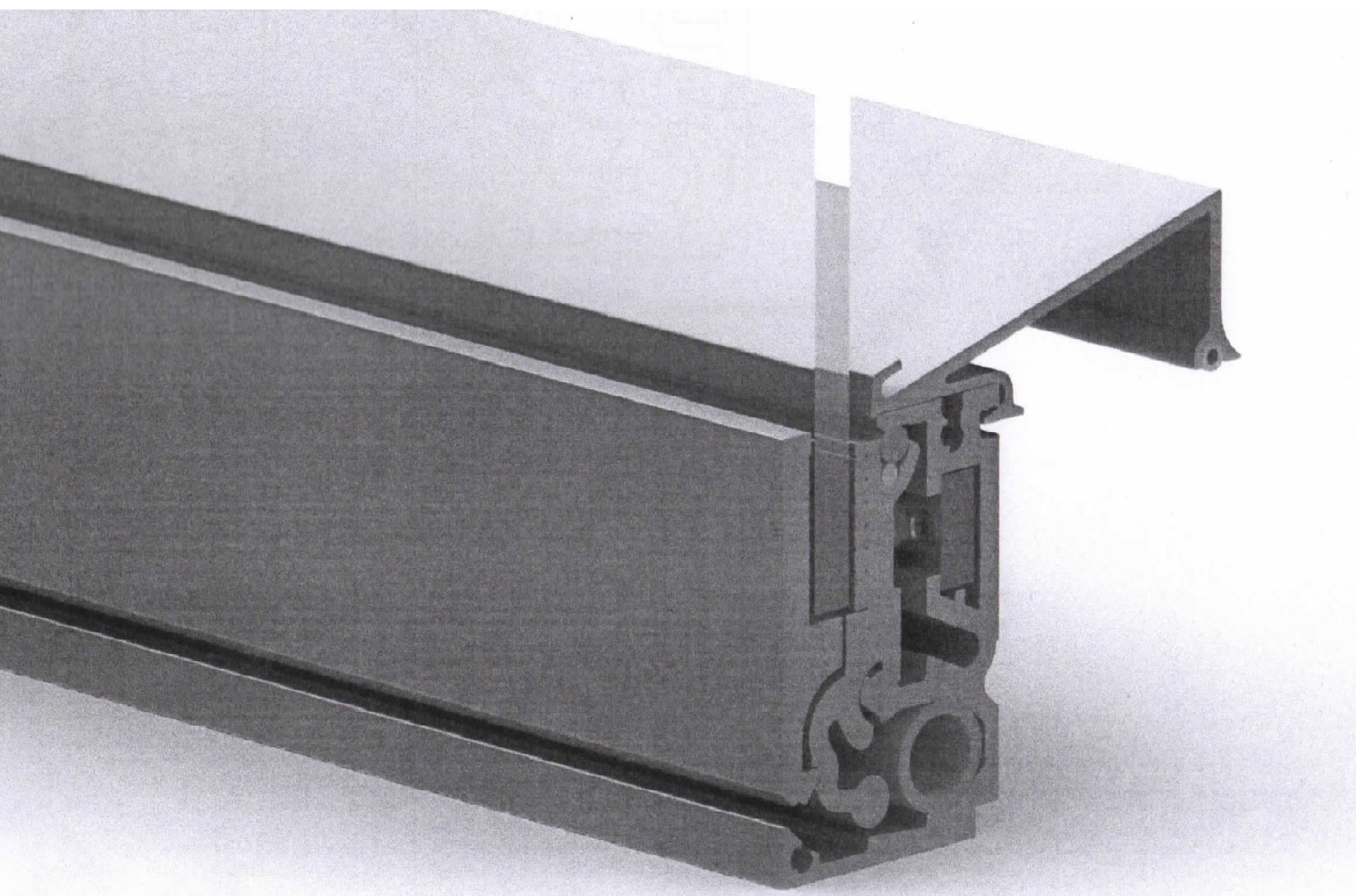
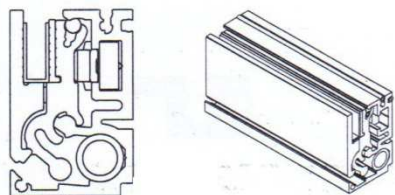

profil Kipp 100 glace de 6mm  
**ref. 07.443.4530.11 / 16**  
dim. 5000 x 39 x 59mm  
alu anodisé argent / noir

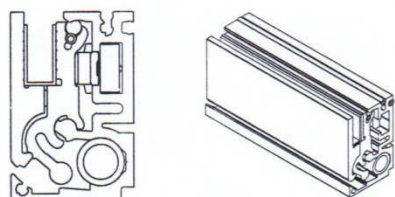

profil Kipp 100 glace de 8mm  
**ref. 07.443.4531.11 / 16**  
dim. 5000 x 39 x 59mm  
alu anodisé argent / noir



profil porte étiquette  
**ref. 07.052.3534.11 / 16**  
dim. 5000  
alu anodisé argent / noir

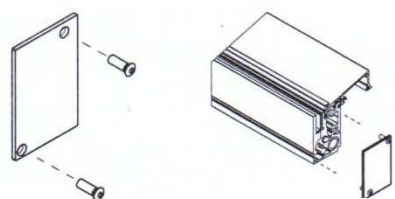

embout sans porte étiquette  
**ref. 07.443.4502.11 / 16**  
alu anodisé argent / noir

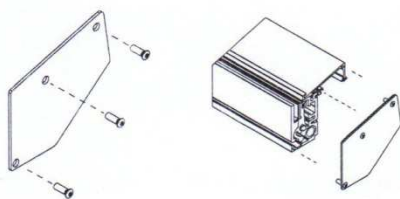

embout avec porte étiquette  
**ref. 07.443.4503.11 / 16**  
alu anodisé argent / noir



butée d'arrêt  
**ref. 07.443.4511.00**

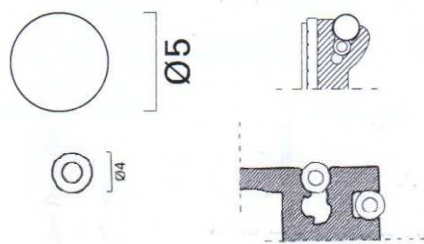

joint PVC diam.5 pour profil mâchoire  
**ref. 07.054.0650.86**  
dim. 3000 x 5mm

joint PVC diam. 4 pour profil de repos  
**ref. 07.054.0547.87**  
dim. 5000 x 4mm

